

**PLAN**

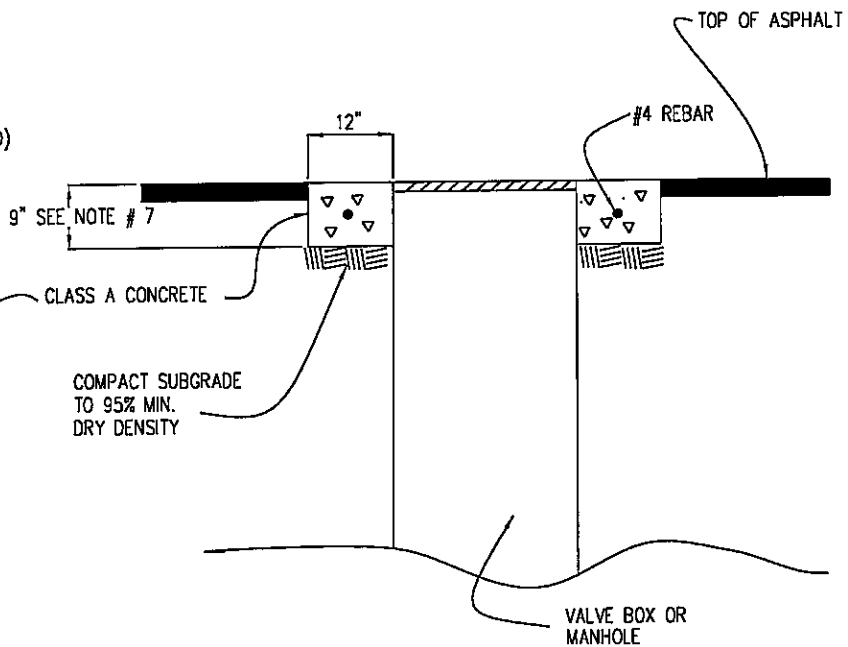

**SECTION**

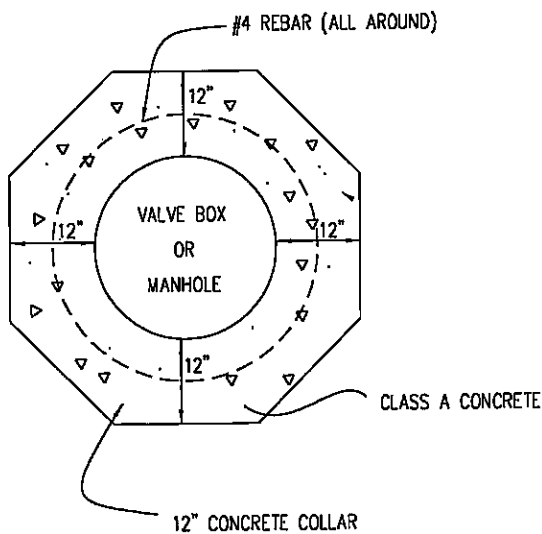

**PLAN  
OPTIONAL**

**NOTES:**

- 1- MANHOLES, VALVE BOXES AND OTHER SIMILAR ITEMS SHALL BE ADJUSTED TO GRADE AFTER PAVING IS COMPLETE.
- 2- THE SURFACE OF THE ADJUSTED RING SHALL MATCH THE GRADE OF THE CONCRETE COLLAR. CONCRETE COLLAR SHALL BE 1/8" - 1/4" LOWER THAN ASPHALT.
- 3- ASPHALT SHALL BE CUT IN STRAIGHT VERTICAL LINES.
- 4- ADJUSTMENTS TO GRADE SHALL BE MADE WITH STANDARD RINGS OR EXTENTIONS OR AS APPROVED BY THE CITY REPRESENTATIVE.
- 5- ALL MANHOLES, VALVE BOXES AND OTHER SIMILAR ITEMS SHALL HAVE CONCRETE COLLAR AS REQUIRED UNLESS OTHERWISE APPROVED.
- 6- 9" THICK COLLARS SHALL BE REINFORCED.  
12" THICK COLLARS DO NOT REQUIRE REINFORCEMENT.
- 7- MARK CONCRETE COLLAR ON WATER VALVE BOXES WITH ARROW INDICATING DIRECTION OF FLOW.

CITY OF ST. GEORGE ENGINEERING DEPARTMENT

REVISIONS		
DATE	DESCRIPTION	BY

**MANHOLES & VALVE BOXES  
CONCRETE COLLAR**

STANDARD DWG. NO.	
171	1 OF 1
APPROVED:	
DATE:	BY: LBB